

NOTES:

1. IMPACT RESISTANT GLAZING OPTION- IMPACT RESISTANT GLAZING SYSTEM MAY BE INSTALLED IN TOP OR INTERMEDIATE SECTION (WITH OR WITHOUT DECORATIVE INSERTS). GLAZING SHALL BE 1/4" POLYCARBONATE. MAXIMUM GLAZING DIMENSIONS SHALL BE 10.72" x 37.85" CUTOUT, FASTENED WITH #8 X 1" SMS: 3X ALONG THE HORIZONTAL AND 2X ALONG THE VERTICAL. SEE DETAIL E ON SHEET 2 FOR ASSEMBLY DETAILS.

2. NON-IMPACT RESISTANT GLAZING OPTION - .090" MINIMUM SSB GLAZING IN MOLDED FRAMES SCREWED TOGETHER WITH A MINIMUM OF (10) #8x1" SCREWS INSTALLED IN TOP OR INTERMEDIATE SECTION (WITH OR WITHOUT DECORATIVE INSERTS) MEETS UNIFORM STATIC WIND PRESSURES SHOWN ON THIS DRAWING. GLAZING SHALL HAVE A MAXIMUM HEIGHT OF 10.72" AND A MAXIMUM LENGTH OF 37.85". GLAZING IS NOT IMPACT RESISTANT AND DOES NOT MEET THE REQUIREMENTS FOR WIND-BORNE DEBRIS REGIONS.

3. VINYL OR WOOD DOOR STOP NAILED A MAXIMUM OF 6" O.C. MUST OVERLAP TOP AND BOTH ENDS OF PANELS MINIMUM 7/16" TO MEET NEGATIVE PRESSURES.

4. KEY LOCK, SLIDE LOCKS, OR OPERATOR REQUIRED.

5. LOUVER OPTION - .040" MINIMUM LOUVERS IN MOLDED FRAMES SCREWED TOGETHER WITH A MINIMUM OF (10) #8x1" SCREWS INSTALLED IN THE BOTTOM SECTION. LOUVERS ARE NOT IMPACT RESISTANT AND DO NOT MEET THE REQUIREMENTS FOR WIND-BORNE DEBRIS REGIONS.

6. SECTION STEEL TO HAVE A MINIMUM 26 GA THICKNESS.

7. THE DESIGN OF THE SUPPORTING STRUCTURAL ELEMENTS SHALL BE THE RESPONSIBILITY OF THE PROFESSIONAL OF RECORD FOR THE BUILDING OR STRUCTURE AND IN ACCORDANCE WITH CURRENT BUILDING CODES FOR THE LOADS LISTED ON THIS DRAWING.

8. DOOR JAMB TO BE MINIMUM 2x4 STRUCTURAL GRADE LUMBER. REFER TO JAMB CONNECTION SUPPLEMENT FOR ATTACHMENT TO SUPPORTING STRUCTURE.

9. FOR LOW HEAD ROOM LIFT CONDITIONS, TOP BRACKET SHALL BE A 13 GA LHR 7/4 TOP BRACKET WITH A MINIMUM OF (3) 1/4-14x7/8" SELF DRILLING CRIMPTITE SCREWS IN LIEU OF THE BRACKET SHOWN ON THIS DRAWING. U-BAR ON TOP SECTION SHALL BE INSTALLED ON TOP OF LHR TOP BRACKETS.

- 13 GA HORIZ ANGLE
- 13 GA FLAG ANGLE
- 15 GA MIN HORIZ TRACK
- 5/16x1-5/8" LAG SCREW (MIN 4 AS SHOWN)
- (4) 1/4-20x9/16" LARGE HEAD TRACK BOLTS OR 1/4-20 STUDS WITH 1/4-20 HEX NUTS
- 15 GA MIN VERT TRACK
- 1/4-20x9/16" TRACK BOLT AND 1/4-20 HEX NUT AT EACH JB-US JAMB BRACKET LOCATION
- 5/16x1-5/8" LAG SCREW AT EACH JAMB BRACKET
- 15 GA STIFFENED JAMB BRACKETS SEE SCHEDULE FOR QUANTITY, LOCATION, AND TYPE
- KEY LOCK OR SLIDE LOCK EACH END (NOT REQUIRED WITH OPERATOR - SEE NOTE 4). SLIDE LOCK SHOWN FOR CLARITY

NOTE: (4) SECTION SOLID DOOR SHOWN. SEE SHEET 2 FOR U-BAR LOCATIONS ON DOORS WITH OTHER SECTION QUANTITIES AND SEE NOTES 1 AND 2 THIS SHEET FOR GLAZING OPTIONS.

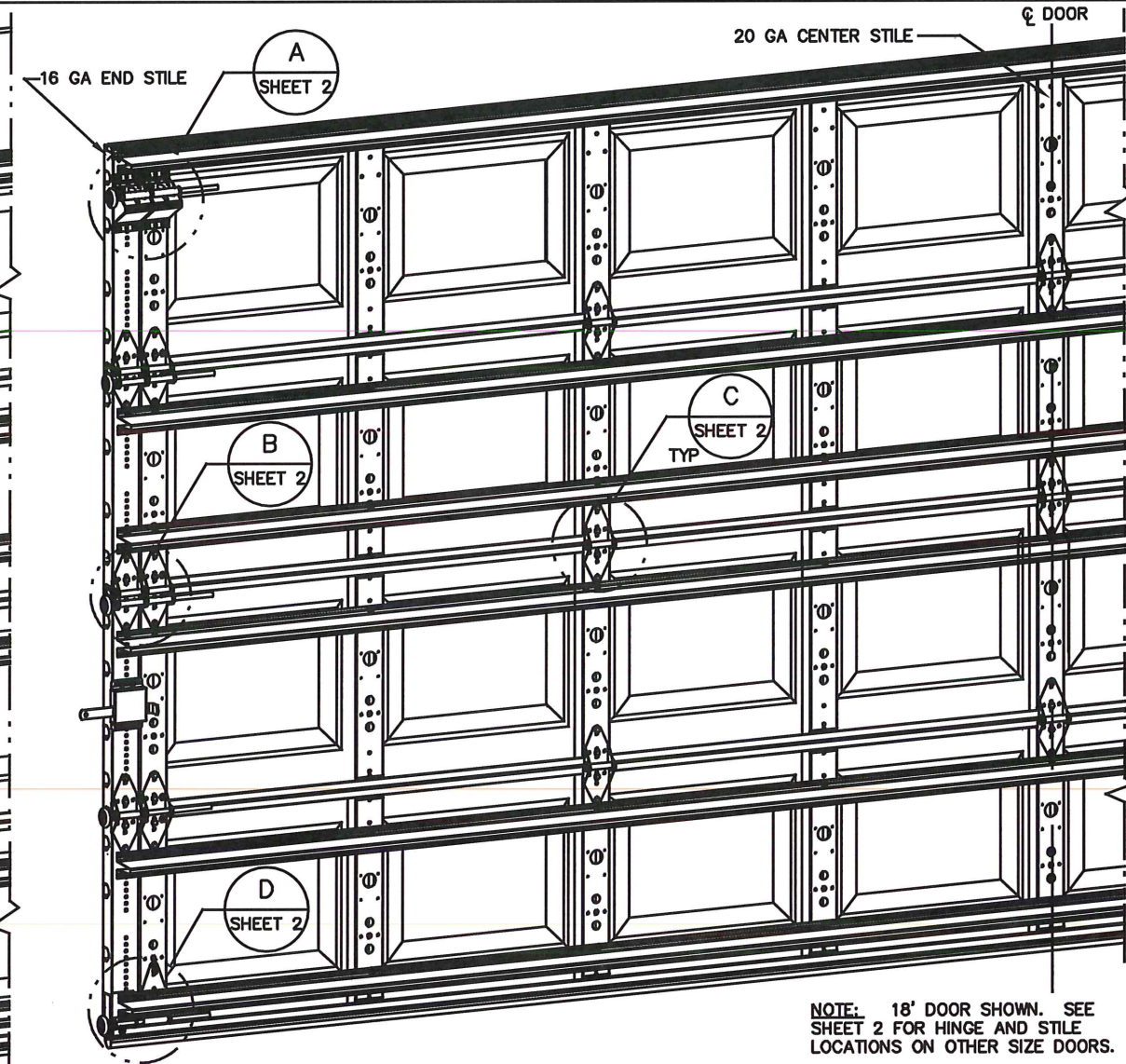

NOTE: 18' DOOR SHOWN. SEE SHEET 2 FOR HINGE AND STILE LOCATIONS ON OTHER SIZE DOORS.

- REVISIONS**
- P1 MODIFIED NOTES TO STATE THAT LOUVERS ARE NOT IMPACT RESISTANT. GRT 6/29/07
 - P2 ADDED IMPACT RESISTANT GLAZING. ADDED DETAIL E SHEET 2 FOR GLAZING. ADDED MAX GLAZING DIMENSION TO NOTES SHEET 1. MODIFIED JAMB BRACKET SCHEDULE. ADDED TRACK TO FLAG CONNECTION NOTE. GRT 11/10/07
 - P3 MODIFIED LOUVER OPTION. ADDED TEXAS LICENSE NUMBER TO TITLE BLOCK. GRT 9/19/08
 - P4 UPDATED TITLE BLOCK AND IMPACT GLAZING GRT 4/16/12
 - P5 UPDATED NOTE 1 & 2 REMOVED U-BARS. ESC 11/8/16
 - P6 UPDATED TITLE BLOCK ESC 10/3/17
 - P7 UPDATED TITLE BLOCK, PER ER 31052 ESC 5/31/18
 - REV H ADDED IRC/IBC NOTE TLC 4/12/21

SUPERIMPOSED DESIGN PRESSURE LOADS ON SUPPORTING STRUCTURE

| DOOR WIDTH | DOOR HEIGHT | UNIFORM LOAD EACH JAMB (PLF) |
|------------|-------------|------------------------------|
| 17'-0" | ALL | +292.4/-325.6 |
| 18'-0" | ALL | +309.6/-344.7 |

JAMB BRACKET SCHEDULE

| DOOR HEIGHT | NO. OF SECTIONS | NO. OF JAMB BRACKETS (EACH JAMB) | LOCATION OF CENTERLINE OF JAMB BRACKETS MEASURED FROM BOTTOM OF TRACK (ALL DIMENSIONS ± 2") |
|-------------|-----------------|----------------------------------|--|
| 6'-6" | 4 | 7 | 2" (JB-US), 10" (JB-US), 21-3/4" (JB-US), 29-3/4" (JB-US), 39" (JB-US), 48" (JB-US), 57-1/4" (JB-US) |
| 7'-0" | 4 | 7 | 2" (JB-US), 10" (JB-US), 21-3/4" (JB-US), 29-3/4" (JB-US), 42" (JB-US), 52-1/2" (JB-US), 63-1/4" (JB-US) |
| 7'-6" | 5 | 9 | 2" (JB-US), 10" (JB-US), 18-3/4" (JB-US), 26-3/4" (JB-US), 36" (JB-US), 45" (JB-US), 54-1/4" (JB-US), 63" (JB-US), 74-1/2" (JB-US) |
| 8'-0" | 5 | 9 | 2" (JB-US), 10" (JB-US), 21-3/4" (JB-US), 29-3/4" (JB-US), 39" (JB-US), 48" (JB-US), 57-1/2" (JB-US), 66" (JB-US), 75-1/2" (JB-US) |
| > 8'-0" | | | SEE NOTE BELOW |

NOTE: (JB-US) FOLLOWING DIMENSION DENOTES SLOTTED JAMB BRACKET ATTACHED TO TRACK WITH 1/4-20x9/16" TRACK BOLT AND NUT AS SHOWN ABOVE. ALL DOORS GREATER THAN 8' IN HEIGHT REQUIRE USE OF CONTINUOUS WALL ANGLE. SEE SUPPLEMENT TRACK CHART FOR DETAILS.

DWAYNE J. KORNISH
4576 COUNTY ROAD 160
MOUNT HOPE, OHIO
FL PE 77845
TX PE 117868

PROFESSIONAL ENGINEER'S SEAL PROVIDED ONLY FOR VERIFICATION OF WINDLOAD CONSTRUCTION DETAILS.

Wayne Dalton
GARAGE DOORS

A DIVISION OF OVERHEAD DOOR CORP
3395 ADDISON DRIVE
PENSACOLA, FLORIDA 32514
(850) 474-9890

COMPLIES WITH THE REQUIREMENTS OF IBC/IRC 2018.

| STATIC PRESSURE RATINGS | APPROVED SIZES | SCALE: N.T.S. | SIZE: A |
|---|-------------------------|------------------|---------|
| DESIGN (PSF): +34.40/-38.30 | MAX WIDTH: 18'-0" | DATE | NAME |
| TEST (PSF): +51.60/-57.45 | MAX HEIGHT: 14'-0" | DRAWN | GRT |
| IMPACT/CYCLIC RATED (YES/NO): YES | MAX SECTION HEIGHT: 21" | CHECKED | TLC |
| MODELS 8000/8100 | | SHEET 1 OF 2 | |
| WINDLOAD SPECIFICATION OPTION CODE 1142 | | DRAWING PART NO. | REV. |
| | | 327022 | H |

13 GA ROLLER SLIDE ATTACHED TO BRACKET WITH 5/16-18 BOLT & NUT IN CENTER SLOT AND 1/4-20x9/16" TRACK BOLT & 1/4-20 HEX NUT THROUGH ANY TWO ALIGNING HOLES

(2) 13 GA COMMERCIAL 'A' FRAME TOP BRACKETS EACH ATTACHED WITH (4) 1/4-14x7/8" SELF DRILLING CRIMPTITE SCREWS

ADD (2) 1/4-14x7/8" SELF DRILLING CRIMPTITE SCREWS (INSIDE OF EACH INSIDE END HINGE)

2" STEEL ROLLER WITH 9" GRADE 1144 OR EQUIVALENT STEM AND 7/16" PUSHNUT AT EACH ROLLER LOCATION. 1/4" MAX BETWEEN PUSHNUT AND BRACKET OR HINGE

14 GA WIDE BODY END HINGE ATTACHED WITH (4) 1/4-14x5/8" SELF TAPPING SCREWS

14 GA WIDE BODY INTERMEDIATE HINGE ATTACHED WITH (4) 1/4-14x5/8" SELF TAPPING SCREWS

12 GA EXTENSION BRACKET ATTACHED WITH (3) 1/4-14x7/8" SELF DRILLING CRIMPTITE SCREWS (2 THROUGH STRUT AND BRACKET)

14 GA BOTTOM BRACKET ATTACHED WITH (2) 1/4-14x7/8" SELF DRILLING CRIMPTITE SCREWS THROUGH STRUT AND BOTTOM BRACKET AND (1) 1/4-14x5/8" SELF DRILLING TAMPER RESISTANT SCREW

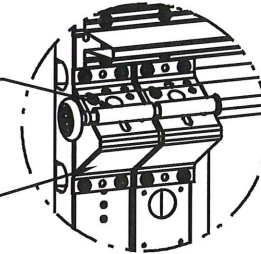

DETAIL A

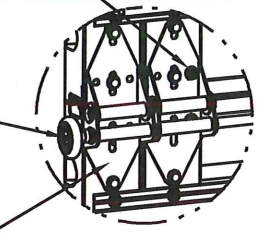

DETAIL B

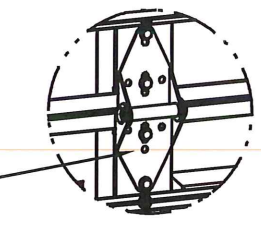

DETAIL C

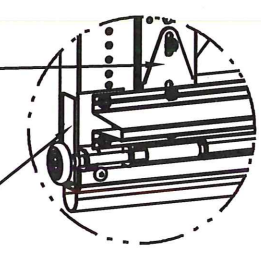

DETAIL D

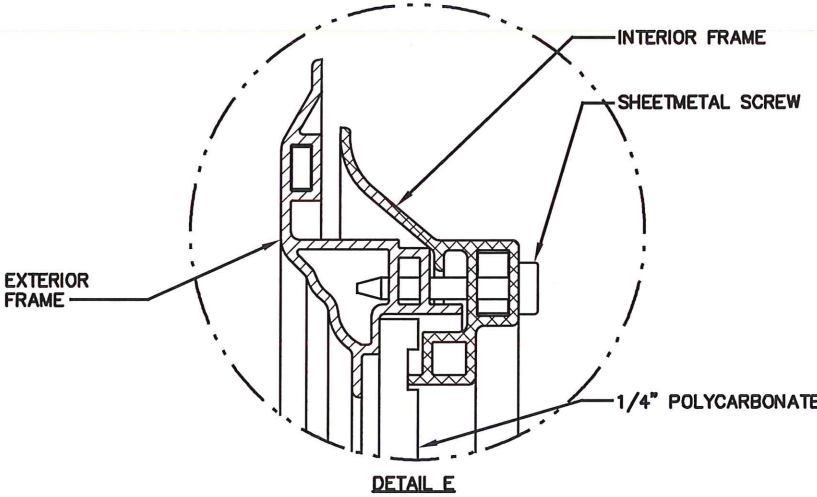
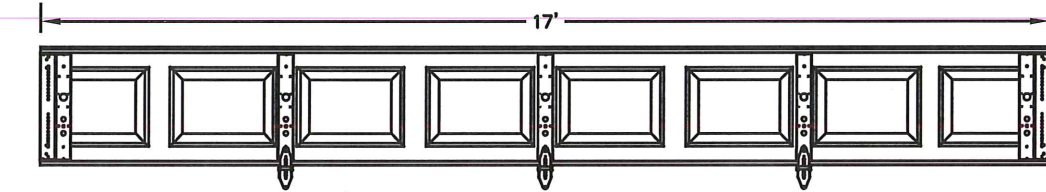
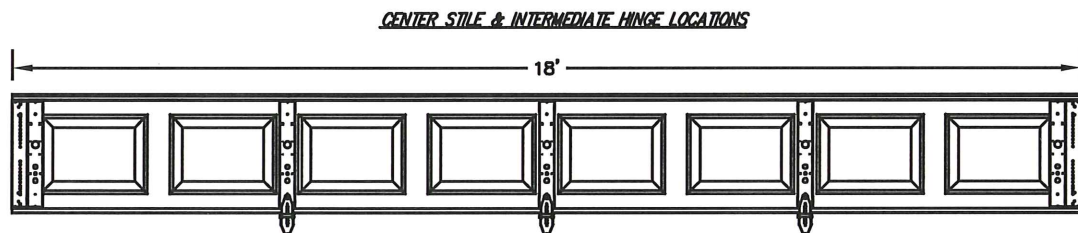

DETAIL E

U-BAR LOCATIONS

(8) SECTION DOORS WITH (12) 3" 18 GA 80 KSI U-BARS LOCATED AS SHOWN

(7) SECTION DOORS WITH (11) 3" 18 GA 80 KSI U-BARS LOCATED AS SHOWN

(6) SECTION DOORS WITH (9) 3" 18 GA 80 KSI U-BARS LOCATED AS SHOWN

(5) SECTION DOORS WITH (8) 3" 18 GA 80 KSI U-BARS LOCATED AS SHOWN

(4) SECTION DOORS WITH (6) 3" 18 GA 80 KSI U-BARS LOCATED AS SHOWN

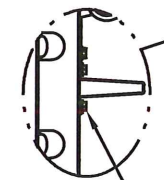

ATTACH U-BAR WITH (2) 1/4-14x7/8" SELF DRILLING CRIMPTITE SCREWS AT EACH STILE LOCATION, TYP.



DWAYNE J. KORNISH, PE
4578 COUNTY ROAD 160
MOUNT HOPE, OHIO
FL PE 77845
TX PE 117868

PROFESSIONAL ENGINEER'S SEAL PROVIDED ONLY FOR VERIFICATION OF WINDLOAD CONSTRUCTION DETAILS.



A DIVISION OF OVERHEAD DOOR CORP
3395 ADDISON DRIVE
PENSACOLA, FLORIDA 32514
(850) 474-9890

| | | | | | | | |
|---|---------------|-------------------------|--------|------------------|---------|---------|-----|
| STATIC PRESSURE RATINGS | | APPROVED SIZES | | SCALE: N.T.S. | | SIZE: A | |
| DESIGN (PSF): | +34.40/-38.30 | MAX WIDTH: | 18'-0" | DATE | 5/23/06 | NAME | GRT |
| TEST (PSF): | +51.60/-57.45 | MAX HEIGHT: | 14'-0" | DRAWN | 4/12/21 | TLC | |
| IMPACT/CYCLIC RATED (YES/NO): YES | | MAX SECTION HEIGHT: 21" | | CHECKED | | | |
| MODELS 8000/8100 | | | | SHEET 2 OF 2 | | | |
| WINDLOAD SPECIFICATION OPTION CODE 1142 | | | | DRAWING PART NO. | | REV. | |
| | | | | 327022 | | H | |